

Southport Eastern Access Corridor

Phasing Plan March 2025

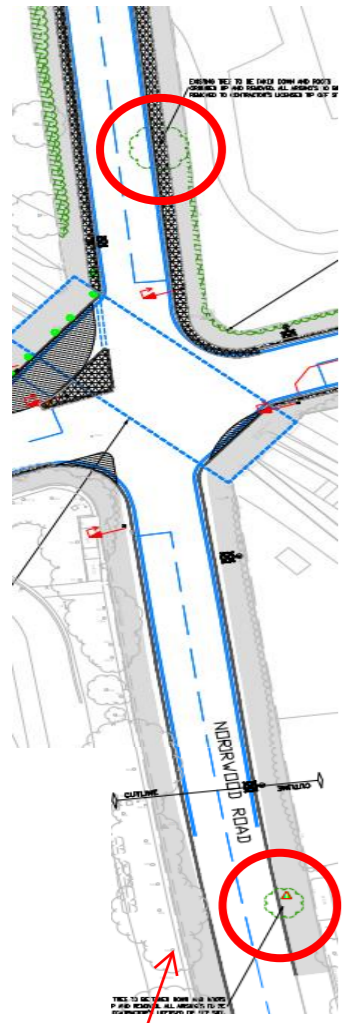

Removal of 2 trees at Bispham Road junction on 06/03/2025.
4-way traffic lights in place between 10:30 - 15:30

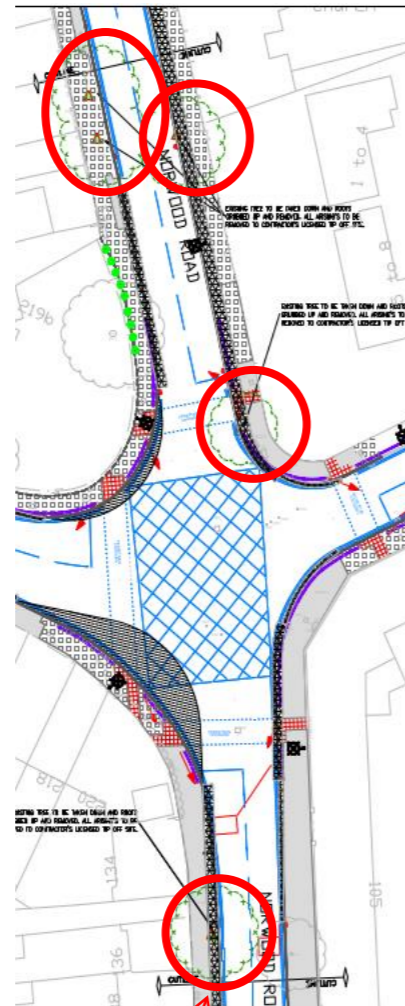

Removal of 5 trees at Sussex Road junction on 07/03/2025 & 10/03/2025.
2-way traffic lights in place at the following times

- 10:30 - 15:30 on 07/03/2025
- 09:30 - 15:30 on 10/03/2025

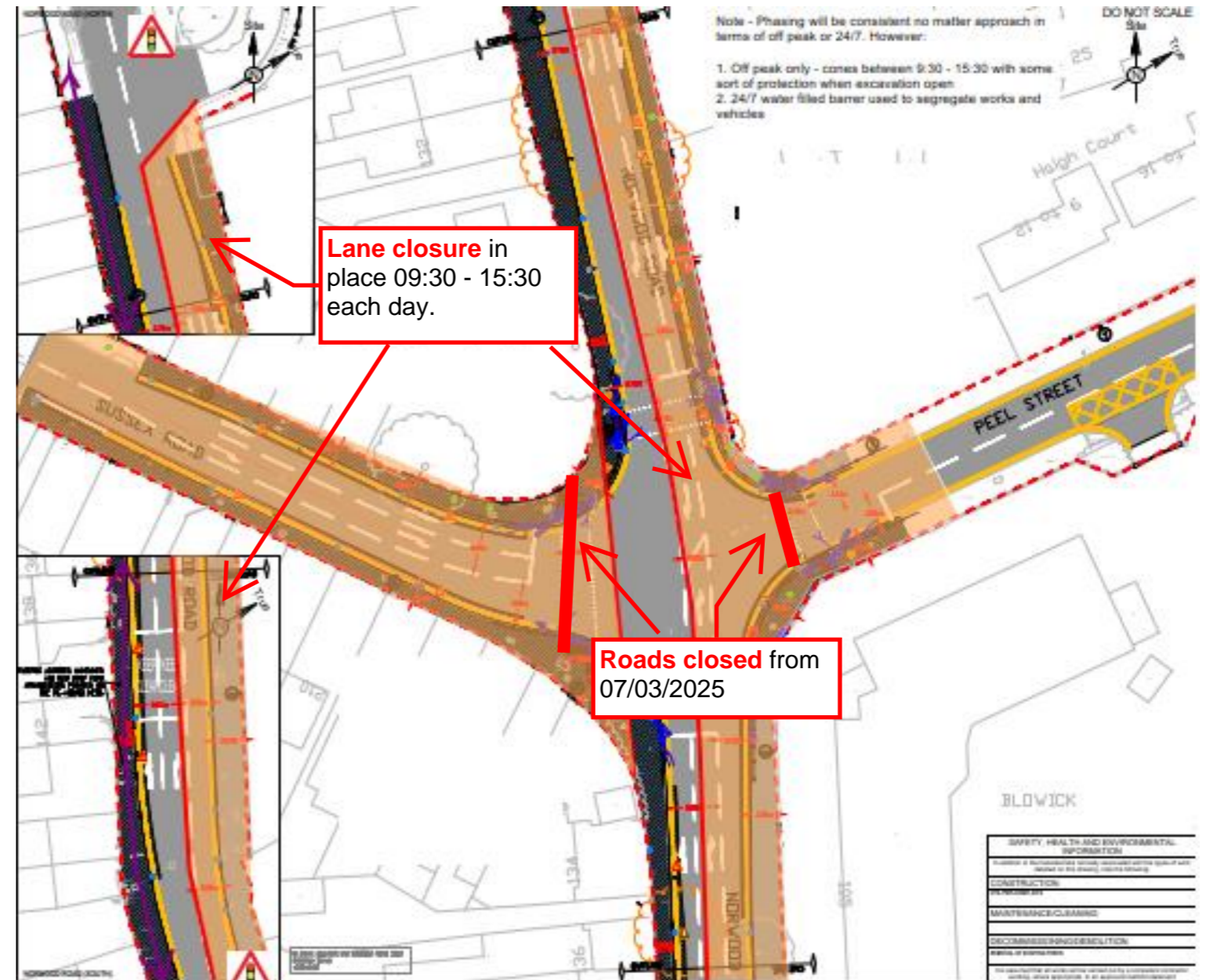

Sussex Road & Peel Street to be closed from 07/03/2025 until 04/08/2025
Main works to begin on 10/03/2025 on Norwood Road. 2-way traffic signals to be in place from 09:30 - 15:30 each day.

Works in the month include the following:

- Kerb removal
- Remove surfacing
- Install gullies & drainage
- Install ducting